

**KOV Forum Newsletter –  
NEXT public meeting on  
16th June 2016, Knight's  
Walk exhibition  
today, Neighbourhood  
Plan logo competition,  
Night tube latest, Vauxhall  
survey works started,**

# night tube for Vauxhall, new pop up Museum coming up & more...

**Dear Members & Friends**

Please find below our latest news & updates:

## **Next KOV Forum Public meeting**

The next KOV Forum public meeting will take place on the 16th June 2016 at the Carmelita Centre. Please see flyer-agenda below for full details.

## **KOV Forum**

### **Public Meeting**

**16<sup>th</sup> June 2016**

**When: 6:15pm – Registration; 6:30pm - Start of meeting**

**Where: Carmelita Centre, 41 Vauxhall Walk, SE11 5JT (Corner of Vauxhall Walk & Jonathan Street - wheelchair accessible)**



**Agenda**

**1. Neighbourhood Plan Workshop** - Which green spaces are important to you and which open spaces can be used for housing? Which sites need special protection and designation? How should we spend money coming into the area with the plan? What do you want to say about tall buildings, basement developments and general design in the area to make it a better place?

**2. Safer Neighbourhoods** - Philip Normal, Safer Neighbourhoods Ward Panel Chair presents

**3. Any other business**

**4. Tea / coffee & networking**



For more information or how to join us, please visit our website [www.kovforum.org.uk](http://www.kovforum.org.uk)  
If you require crèche, please let us know by 12noon on 10th June 2016

KOV Forum is supported by:  LAMBETH FORUM NETWORK

**Prize Draw**

Win!

If you attend our meeting, as a thank you for your time, we are holding a prize draw. There are two £10 Amazon vouchers to win.

Terms & Conditions:

- Fill in your details below and hand in at the start of the meeting. Slips will be put into a draw held at the end of the meeting.
- For the chance to win you need to be present to claim your prize and have registered by 6.30pm.
- By entering you will also be signing up KOV Forum membership (see website for details)

Name & Surname: \_\_\_\_\_ Signature: \_\_\_\_\_

Address: \_\_\_\_\_ Postcode: \_\_\_\_\_

**Neighbourhood Plan Logo Competition**

We are launching a Neighbourhood Plan logo competition that is open to all our members. A £20 voucher will be awarded to the winning entry to be spent in the Oval Farmer's Market. We would like a logo that will escort all our future Neighbourhood Plan communications and publicity. Our Plan is working to make sure there is more greenspace, buildings that aren't so tall and limit basement development. We are keen to keep what is special about the area, and get everyone involved to make this a special part of London that we all love to live and work in. Your design needs to reflect this aspiration. Please find below the Terms & Conditions:

- The logo entries must be sent to [forumkov@gmail.com](mailto:forumkov@gmail.com) (mailto:forumkov@gmail.com) by 10m - 30th June 2016.
- The logo must be submitted in high resolution
- The logo must be original and must relate to the KOV Forum catchment area
- The winning entry will become the property of KOV for use in any way it sees fit in association with promoting the Neighbourhood Plan.
- The KOV Board will shortlist the best entries and their decision is final. No feedback will be provided.
- One entry per household is allowed.



### **Vauxhall TfL Survey works**

From Sunday 29 May 2016 for around 10 weeks, roads around Vauxhall will be busier than usual while surveying work takes place. Please see link below for full details:

[tfl.gov.uk/status-updates/major-works-and-events/vauxhall-works](https://tfl.gov.uk/status-updates/major-works-and-events/vauxhall-works)  
(<https://tfl.gov.uk/status-updates/major-works-and-events/vauxhall-works>)



### **Night tube - update**

Night Tube latest: From 19th August 2016 Vauxhall, Oval & Kennington stations will be open all hours of the weekend. Full details can be found at [tfl.gov.uk/campaign/tube-](http://tfl.gov.uk/campaign/tube-)

improvements/what-we-are-doing/night-tube

(<https://tfl.gov.uk/campaign/tube-improvements/what-we-are-doing/night-tube>)

**Night Tube**  
Operates on Friday and Saturday nights

**Night Tube operates on Friday and Saturday nights**

- Central line
- Jubilee line
- Northern line
- Piccadilly line
- Victoria line

**MAYOR OF LONDON**

**TRANSPORT FOR LONDON**  
EVERY JOURNEY MATTERS

*FREE THE NIGHT*

The image is a detailed map of the London Underground Night Tube service. It features a dark blue background with a grid of station names. Five colored lines represent the operating routes: Central (red), Jubilee (orange), Northern (yellow), Piccadilly (green), and Victoria (blue). A legend in the top left corner identifies these lines. The map includes various icons for services like 'Arrives at South Acton station' and 'Night Tube operates on Friday and Saturday nights'. At the bottom, there are social media links for tfl.gov.uk, TfL Travel Alerts, and the Transport for London logo. The slogan 'FREE THE NIGHT' is written in a stylized font at the bottom left, and a silhouette of a person with arms raised against a starry night sky is at the bottom right.

**8 Albert Embankment (Fire Station) - pop up Museum**

8 Albert Embankment (Fire Station) Update. Planning application for a pop up museum. Reference: 16/03122/FUL | Change of use from Workshop (Use Class Sui Generis) to a Museum and event space (Use Class D1) for a temporary period of 18 Months starting from 1st July 2016. | 8 Albert Embankment London SE1 7SP. Full details at the planning portal at [planning.lambeth.gov.uk/online-applications/applicationDetails.do?activeTab=documents&keyVal=O7N5FPBOGQB00](http://planning.lambeth.gov.uk/online-applications/applicationDetails.do?activeTab=documents&keyVal=O7N5FPBOGQB00) (<http://planning.lambeth.gov.uk/online-applications/applicationDetails.do?activeTab=documents&keyVal=O7N5FPBOGQB00>)



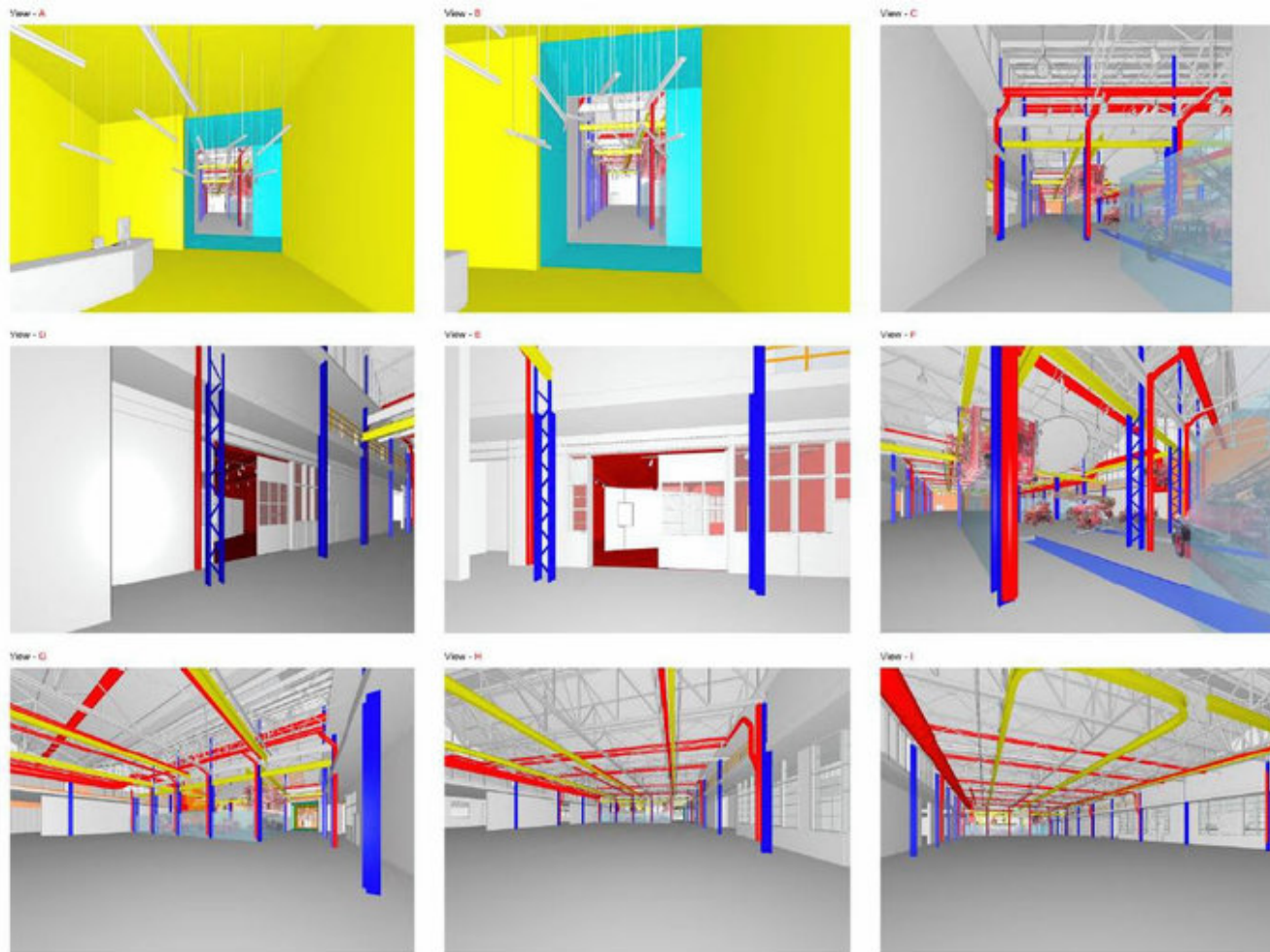

## **One Nine Elms - update**

Tuesday 31st May - Friday 3rd June

Coring of existing piles, formation of new bearing piles and installation of plunge columns will continue to take place throughout the week.

Piling works for the new diaphragm wall will be carried out.

Hydro demolition works to the remaining section of raft slab.

The existing cased piles will be removed.

Additional monitoring stations will be set up across the site.

The overpumping equipment on site will be relocated.

The working hours for the next week are:

Saturday: 0800-1300

Sunday and Monday: No works

Tuesday-Friday: 0800-1800

Wandsworth Council have granted permission for piling works to continue outside of normal hours until 11pm during the week when necessary. Any works taking place after 6pm will only be concreting operations and will not involve the noisy coring of piles.

More questions?

Contact Details

E: [onenineelms@cascadepr.co.uk](mailto:onenineelms@cascadepr.co.uk)

(<mailto:onenineelms@cascadepr.co.uk>)

Freephone: 08082 819 538

W: [onenineelms.co.uk](http://www.onenineelms.co.uk) (<http://www.onenineelms.co.uk>)



## **Barbara Hepworth Summer Garden Party**

A free event for the community is taking place next to  
Beaconsfield Gallery

When: 10th June @ 2pm

Where: Pop-up sculpture park next to Beaconsfield Gallery



## **Have you seen any graffiti or flyposting?**

Please be reminded that you can report graffiti/flyposting occurrences online at [lambeth.gov.uk/forms/report-graffiti-and-flyposting-form](https://www.lambeth.gov.uk/forms/report-graffiti-and-flyposting-form) (<https://www.lambeth.gov.uk/forms/report-graffiti-and-flyposting-form>)

Created with Wix ShoutOut Love It? Try it! It's Free. ([http://shoutout.wix.com?utm\\_campaign=vir\\_shoutout&referralInfo=SO\\_LP](http://shoutout.wix.com?utm_campaign=vir_shoutout&referralInfo=SO_LP))



### **VGERTA's 'Hayverley Garden Point' now open**

Cllr Lip Peck, Leader of Lambeth Council, official opened the transformed community garden located behind the Carmelita Centre on Vauxhall walk. VGERTA working in collaboration with

Lambeth Housing to transform this corner of Vauxhall. More photos from the opening can be found on VGERTA's facebook by [clicking here](https://www.facebook.com/VGERTA/) (<https://www.facebook.com/VGERTA/>).



**Lambeth Country Show**

The Lambeth Country Show returns to Brockwell Park on Saturday 16 and Sunday 17 July 2016, boasting a unique line-up that celebrates the very best of the city and countryside. Please follow the link below for full details [lambethcountryshow.co.uk](http://lambethcountryshow.co.uk) (<http://lambethcountryshow.co.uk/>)



### **Vauxhall City Farm - update**

Vauxhall City Farm's 'The Old Dairy Cafe' & new Education Centre are now open.



### **Lambeth Community Pride Awards**

If you know someone or a group of people who go the extra mile to make a positive contribution to the lives of others in the community, please nominate them by 5 June 2016. Visit [lambeth.bov.uk/communitypride](http://www.lambeth.bov.uk/communitypride) (<http://www.lambeth.bov.uk/communitypride>) for further information.





### **Knights Walk Housing Design Principles Exhibition**

Where? Pedlars Acre Hall, 1 Opal Street, Kennington, London SE11 4HZ

When? Wednesday, 1st June from 4:30pm - 7pm

What? Housing Design Principles Exhibition

The Council has developed Housing Design Principles for the new homes that will be built for a range of tenures. In building new homes, the Council will be taking a longterm view; homes that fit well into the neighbourhood and stand the test of time; they need to create a positive legacy for a future Lambeth; they

need to be high quality, low maintenance and low energy. And they need to help create and support resilient mixed neighbourhoods for everyone.

### Meet the Development Management Team

Following an extensive selection process, in which residents were able to meet the potential development management teams and took part in interviewing them, the Council has appointed Tibbalds Campbell Reith Joint Venture to develop the partial redevelopment proposals for Knight's Walk. You can meet the team at the exhibition and find out about the programme for developing the design and making a planning application. My company, make:good, will be leading on the resident and stakeholder engagement work as the project develops so I particularly look forward to meeting people and hearing first hand their questions, comments and concerns.



## **EU Referendum > Reminder > Register to vote by Tuesday 7**

### **June**

If you want to vote in the EU Referendum and you are not already registered, you need to register now – visit [gov.uk/register-to-vote](http://www.gov.uk/register-to-vote) (<http://www.gov.uk/register-to-vote>) or call 020 7926 2254 or email [electoralservices@lambeth.gov.uk](mailto:electoralservices@lambeth.gov.uk) (<mailto:electoralservices@lambeth.gov.uk>) Please also pass this on to your neighbours and encourage as many people in our area to register as possible.



Please note that 9th June 2016 (4pm) is the deadline for any requests for news/updates inclusion in our next newsletter.

**Regards,**

**Chrysostomos (Chrys)**

**KOV Forum Secretary**

**Web** (<http://www.kovforum.org.uk/>) / **Twitter**

(<https://twitter.com/kovforum>) / **Facebook**

(<https://www.facebook.com/KovForum?fref=photo>)



(<http://www.kovforum.org.uk>)

**Disclaimer:** KOV is an apolitical volunteer organisation. We pass on information we believe is useful to the community and do not necessarily endorse any particular views that may be expressed. We can accept no liability for any errors in the information supplied to us.

Share Via:



(htt

[www.kovforum.org.uk](http://www.kovforum.org.uk) 

(<http://www.kovforum.org.uk>)